



AUTOMOTIVE SOLUTIONS



190100576

# MED-CALL

JANUARY 2015

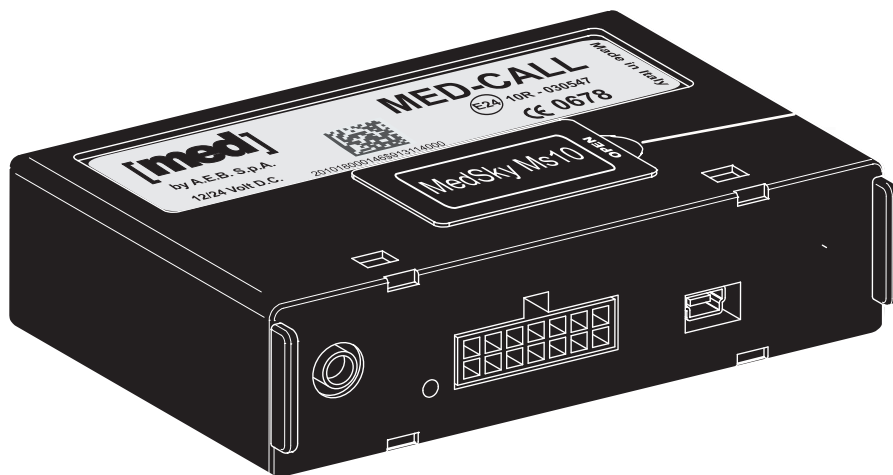

## INSTRUCTION MANUAL

**CONNECTION** and **ASSEMBLY** from page 8

Remote alarm communication system with  
“telephone cell” indication

Integrated GSM telephone.

SMS warnings to 10 mobile phones.

Warning phone call to Main User.

3 different alarms sent, 2 with customizable message.

**- ENGLISH -**

COMPANY  
WITH QUALITY SYSTEM  
CERTIFIED BY  
BUREAU VERITAS  
ISO 9001:2008

A.E.B. S.p.A. a socio unico / a single member Company - Via dell'Industria, 20  
42025 - Corte Tegge - Cavriago (RE) - Italy  
med è una divisione di / a division of A.E.B. S.p.A. [www.medautomotive.it](http://www.medautomotive.it)  
Ph.+39 0522 494486 - Fax +39 0522 494410 - e-mail: [service@medautomotive.it](mailto:service@medautomotive.it)



## INTRODUCTION

**MED-CALL** can send up to 3 different alarms to 10 different mobile phones, plus a warning call (which can be disabled) to the mobile phone of the Main User.

If available, it also indicates the "telephone cell" linked to the system.

It can manage **periodic warning messages**, and can indicate when the system is **out of order** (functions to be activated via SMS), which proves useful to check the system's efficiency over time and also to keep the SIM CARD under control.

Communications are performed via the integrated telephone module that can exploit the **Voice** and **SMS** channels.

It can be used on totally different types of vehicles, for example, on cars, commercial and industrial vehicles, trucks, camper vans, operating machines, farming machines, trailers, boats etc.

## SIM-CARD

**MED-CALL** requires a **SIM-CARD**, which you can purchase from Mobile Phone Operators.

The alarm warning can also be forwarded via a telephone call to the Main User (if there is a VOICE line), in addition to the SMS with the type of alarm detected, likewise for the Secondary Users.

### WARNINGS:

- **If the vehicle travels outside the country, make certain that the SIM is enabled for international roaming.**
- We advise you to use a subscription SIM-CARD and not a PRE-PAID or PAY-AS-YOU-GO SIM-CARD, which could make the Service inefficient (Generally speaking if PRE-PAID or PAY-AS-YOU-GO SIM CARDS are not topped-up at least every 8/12 months, the telephone operators may "cancel" them, even there is still credit left on them).
- By using M2M SIM CARDS (no voice, just data and SMS) the system can only be used via SMS.
- Do not use "UMTS" SIM CARDS because they are not compatible.
- If the SIM CARD has a data line, the device can be updated via telephone if a new software release is required.

## WARNINGS

A.E.B. S.p.A. declines any and all responsibility and will revoke the guarantee if the product, or part thereof, is used improperly; if it is tampered with, or if it is combined with any devices that are not listed.

A.E.B. S.p.A. reserves the right to make changes, updates, or technical modifications to the product at any time, without prior notice.

## IMPORTANT:

- **Alarm messages are sent to the mobile telephone of the registered main user (the one that sent the REG ON SMS), and all of those registered as secondary numbers, for a maximum total of 10 mobile phones.**
- **Use of this manual and the commands it contains is reserved for the vehicle owner.**
- **A.E.B. S.p.A. Is NOT responsible for improper use of the product, delays sending alarms, or alarms not sent that depend on the telephone provider, the area "coverage", lack of "credit" for telephone traffic.**

**We recommend that the efficiency of the system be checked periodically.**

- **If a "pre-paid" or "debit" SIM-CARD is used, periodically check the residual credit as the system only functions if the SIM-CARD has sufficient credit for communications (outbound call).**

## MAIN USER MOBILE TELEPHONE REGISTRATION

Send the telephone number to register to the **SMS** number of the **MS10** in the **SMS**:

**REG ON** (with a space between the words)

MED-CALL will automatically save the telephone number that sent this message, enabling it as the "**MAIN TELEPHONE**". The system will reply with the SMS:

"MED-CALL REGISTRATION OF THE NUMBER XXX/XXXXXX AS MAIN USER".

This indicates if you have total or limited access.

**WARNING:** If the date and time are present, these are indicated by the phone service provider and for this reason they can be indicated, regardless, at either the beginning or the end of the message.

If the mobile phone used saves the phone number of the **MED-CALL** SMS, associated with the type or plate number of the vehicle, when you receive a message from this number your mobile phone will indicate which vehicle has sent the message.

- **It is possible to change the registered mobile phone** by sending the "**REG ON**" message from another phone.  
When the command is received, the **MS10** will automatically send an **SMS** to both mobile phones, confirming the new registration and the access status.
- **It is possible to change the registered mobile phone** by sending the "**REG ON**" message from another phone.  
When the command is received, the **MS10** will automatically send an **SMS** to both mobile phones, confirming the new registration and the access status.
- To "display" which phone number is the "MAIN USER", send the SMS:

**REG** (no spaces)

The system reply by SMS with the mobile phone number registered as the main user:

"MED-CALL REGISTRATION OF THE NUMBER XXX/XXXXXX AS MAIN USER".

If it answers: "MED-CALL NO REGISTERED NUMBER" hen there is no "Main user" phone number registered. **The system cannot therefore forward the alarms.**

- If you want to **"delete"** the Main User phone number, without replacing it, send the following SMS:

**REG OFF** (with a space between the words)

The system will reply to the registered mobile phone with the SMS:

"MED-CALL REGISTRATION OF THE NUMBER XXX/XXXXXX AS MAIN USER HAS BEEN CANCELLED".

### **WARNING:**

- If there are any secondary users registered, these numbers will be deleted.
- **The SMS can be written with capital or small letters, indifferently:**
- **Some functions can only be used by the Main User.** If a secondary user attempts to send a command that is unauthorized, the system replies: "USER NOT ENABLED FOR THIS COMMAND" or "COMMAND NOT AVAILABLE".

## SYSTEM RESET

To reset the system, instead of disconnecting the power supply, send this SMS::

**RESET** (no spaces)

All of the previously set-up functions remain operative.

## REGISTRATION OF SECONDARY USERS

In addition to the **MAIN user** (the telephone number automatically registered by sending the **REG ON SMS**), **nine (9) secondary users** can be registered.

These users will receive SMS messages with the alarms detected.

Send the peripheral the telephone numbers from the Main Users phone using the SMS:

**RON <+39xxxxxxxxxxx >** (do not enter the <> parenthesis, type only the space to separate the words. The telephone number in Italy must ALWAYS be preceded by the country code +39).

**Repeat this command for each Secondary User to be registered.**

MED-CALL will save the telephone number and reply to both telephones with the SMS:

“SECONDARY USER HAS BEEN REGISTERED “+xxxxxxxxxxxxx””

or: “SECONDARY USER ALREADY IN THE LIST”, if already registered.

### **WARNING:**

- If the Main User is replaced by a new one, all the secondary users remain registered.
- If you cancel the Main User using the REG OFF SMS all secondary users are eliminated, too.

## DISPLAY OF ALL REGISTERED SECONDARY USERS

Send the following SMS from the Main User telephone:

**RON** (no spaces)

The system will reply indicating the Registered Secondary Users in sequence: “RON “+39xxxxxxxxx”... “+39xxxxxxxxx”” up to a maximum of nine numbers.

If there are no registered secondary users, the answer is: “MED-CALL SECONDARY USER NOT REGISTERED”.

## DELETING ALL SECONDARY USERS

To delete ALL secondary users, leaving only the Main User:

Send the following SMS from the Main User telephone:

**ROFF** (no spaces).

MED-CALL will reply with the SMS: “ALL SECONDARY USERS DELETED”

## DELETING ONE SPECIFIC SECONDARY USER

Use the Main User telephone to send the SMS:

**ROFF >+39xxxxxxxxx>** (do not enter the <> parenthesis, type a space between the words. The telephone number in ITALY must always be preceded by the country code +39).

Repeat this command for each Secondary User to be deleted.

The system will reply indicating the phone number eliminated:

“SECONDARY USER DELETED +XXXXX/XXXXXX”

## DISABLE PHONE CALL OF MAIN USER

By forwarding the SMS from the Main phone, the warning call will not be made to the Main User. Should an alarm trigger, the main user will just receive the SMS, likewise for the secondary users.

**TEL OFF** (with a space between the words)

MED-CALL will reply with the SMS: "TELEPHONE CALL DISABLED".

- To view the phone call settings, send the SMS from the Main phone:

**TEL** (no spaces)

MED-CALL will reply with the SMS:

"TELEPHONE CALL DISABLED" or "TELEPHONE CALL ENABLED".

- To re-activate the warning phone call, forward the SMS from the Main phone:

**TEL ON** (with a space between the words)

MED-CALL will reply with the SMS: "TELEPHONE CALL ENABLED".

## LIMITED ACCESS

By forwarding the following SMS from the Main phone, you stop other users from becoming the Main User. You will still receive a copy of the alarms:

**ACC OFF** (with a space between the words)

MED-CALL will reply with the SMS: "UPDATED ACCESS: RESERVED ACCESS".

- To display the type of access set-up, send the SMS:

**ACC** (no spaces)

MED-CALL will communicate the type of access set-up to the main user telephone number:

"FREE ACCESS" or "RESERVED ACCESS".

With ACC OFF, if the other mobile phones attempt to send a command for which they are not enabled, they will receive the message:

"USER NOT ENABLED FOR THIS COMMAND".

- To revoke the command, or to register a new main user telephone, send the SMS:

**ACC ON** (with a space between the words)

MED-CALL will reply with the SMS: "UPDATED ACCESS: FREE ACCESS".

## RECEIVE VEHICLE POSITION VIA GSM CELL

To find out which "telephone cell" is linked to the system, send this SMS:

**POS** (no spaces)

MED-CALL will reply with the SMS:

**MED-CALL** = device model.

**GSM (LAC, CID): xxxx,xxxx** = telephone cell from which the system is answering.

**Vb: xx.x V** = System power supply voltage.

**WARNING:**

- The "telephone cell" is not always available.
- The "telephone cell" can possibly be identified by the Police if the vehicle is stolen.

## ALARMS

MED-CALL can manage the 3 types of alarms listed below, which are sent first to the mobile phone of the Main User via a silent call, followed by the SMS with the type of alarm detected.

Message	Generated By:
<b>MED-CALL</b>	= device model.
<b>GSM (LAC, CID): xxxx,xxxx</b>	= telephone cell from which the system is answering.
<b>ALARM xxxxxxxxxxxxxxxx</b>	= type of alarm detected.

### LIST OF ALARMS

<b>INPUT 1</b>	Name (changeable) received on input 1 (positive, PINK wire)
<b>INPUT 2</b>	Name (changeable) received on input 2 (positive, BROWN wire)
<b>LOW BATTERY</b>	Main vehicle battery monitoring.

#### WARNING:

- The availability of the “telephone cell” depends on the Telephone Operator.
- The position of the “telephone cell” and therefore of the vehicle can be possibly identified just by the Police if the vehicle is stolen.

### CHANGING THE NAME OF THE ALARMS

The names of the alarms are set by the manufacturer as INPUT 1 (PINK wire) and INPUT 2 (BROWN wire). They can only be changed via SMS from the Main telephone:

INPUT 1: **ALL1 xxxxxxxxxxxxxxxxxxxxxxxx** (with a space between the words)  
INPUT 2: **ALL2 xxxxxxxxxxxxxxxxxxxxxxxx** (with a space between the words)

The system will reply with the SMS: “ALL1 xxxxxxxxxxxxxxxxxxxxxxxx” or “ALL2 xxxxxxxxxxxxxxxxxxxxxxxx”.

Where “xxxxxxxxxxxxxxxxxxxxx” stands for the name to be assigned to the alarm instead of: INPUT 1 and/or INPUT 2. Enter up to 20 digits, including spaces.

**WARNING:** Do not use special digits.

- To re-active the default names (INPUT 1 and INPUT 2), send this SMS:

**ALLD** (no spaces)

MED-CALL will reply with the SMS: “ALARM LABEL ERASED”.

### INPUT 1 and INPUT 2 ALARM

When the input of MED-CALL receives the corresponding alarm signal.

- Indication: **ALARM INPUT 1**, or **ALARM xxxxxxxxxxxxxxxxxxxxxxxx**
- Indication: **ALARM INPUT 2**, or **ALARM xxxxxxxxxxxxxxxxxxxxxxxx**
- The alarm is not sent repeatedly if the signal continues without interruptions.
- It is only sent again if the alarm triggers again at least **120 seconds** from when the first alarm was detected.
- If the 2 alarms are sent simultaneously, just the first one may be forwarded. To forward both, there must be a slight time difference.

### VEHICLE BATTERY DISCHARGED ALARM

When the vehicle's battery is running low (provided it is running low slowly), charge it up again quickly. It does not indicate a rapid disconnection of the power supply.

- Purpose: **ALARM LOW BATTERY**
- The alarm will not be sent repeatedly.

## SYSTEM OUT OF SERVICE

The system can be put **OUT OF SERVICE** if it **must not send alarms**.

For example, if the vehicle is taken to the shop for maintenance, prior to detaching the battery terminals, in order to avoid useless telephone calls or SMS. Send the SMS:

**COM FS** (with a space between the words)

MED-CALL will reply with the SMS: "WARNING: SYSTEM OUT OF ORDER".

**WARNING: Re-activate system as soon as possible.**

When the system is out of order, the LED is usually off. If it is powered and there is a telephone signal, MED-CALL still answers any queries; it can also forward a daily SMS to the Main User to remind the latter that the system is out of order, if the relevant SMS is forwarded:

**COM FS ON** (one space between the words)

The system will reply with the SMS: "MED-CALL OUT OF ORDER WARNING ENABLED".

If you do not want to receive this "reminder", send the SMS:

**COM FS OFF** (one space between the words)

The system will reply with the SMS: "MED-CALL OUT OF ORDER WARNING DISABLED".

## SYSTEM IN SERVICE

To restore sending alarms, send the SMS:

**COM IS** (with a space between the words)

MED-CALL will reply with the SMS: "WARNING: SYSTEM IN SERVICE".

The system will now send any alarms detected.

## SET-UP AUTOMATIC SYSTEM CHECK

You can set the "AUTOMATIC SYSTEM CHECK" function (survival) by setting automatic forwarding of an SMS to check it, for example weekly, provided the system is powered and there is telephone coverage.

To receive the message as from the SMS POS (page 4) from MED-CALL, forward this SMS:

**COM VERIFICA XXXXX** (one space between the words)

Where **XXXXX** = Indicates the period for sending the SMS in minutes.

From **00001** (= 1 minute) to **01440** (= 1 day) up to a maximum of **99999** (almost 70 days).

We recommend **XXXXX = 10080**, which corresponds to **7 days**.

MED-CALL will reply with the SMS: "MED-CALL VERIFY ENABLED".

## ELIMINATION OF AUTOMATIC SYSTEM CHECK

To eliminate the automatic message of the system operation, send the SMS:

**COM VERIFICA OFF** (one space between the words)

The system will reply with the SMS: "MED-CALL VERIFY DISABLED".

## RESET AUTOMATIC SYSTEM CHECK

Reset automatic forwarding of warnings, with the times set previously, by forwarding this SMS:

**COM VERIFICA ON** (one space between the words)

The system will reply with the SMS: "MED-CALL VERIFY ENABLED".

## ENERGY SAVINGS

To minimize the consumption of electricity, MED-CALL is always in stand-by, but is always ready to forward an alarm and to answer queries.

## CONDITIONS OF GUARANTEE

The TECHNICAL GUARANTEE has period of 24 months starting from the date of installation, ex-works, for the parts considered defective according to indisputable discretion of A.E.B. S.p.A. All external work and any other fees for any other reason are EXCLUDED from coverage. The GUARANTEE, accompanied by the **CERTIFICATE OF INSTALLATION**, is automatically void if there are damages due to improper installation, tampering, improper use of the system or parts thereof, combination with devices NOT indicated, or for leakage of liquids.

## MAINTENANCE

The **MED-CALL** does not require any maintenance. **WARNING:**

- **We recommend periodically checking the correct operation of the system.**

You can set automatic forwarding of the SMS to check the system as indicated on page 6.

## APPROVALS

**MED-CALL** is type approved according to the **ECE / ONU R10** regulation including the electromagnetic compatibility tests and is also recognised by non EEC countries such as, for example, Russia, Japan, etc.), with the number:

n. **E24** 10R - 030547

## WARNING

MED-CALL is set-up and fine tuned according to the technical data indicated in the Technical File of the product, summarized in the Declaration of Compliance and the Instructions for Operation and Installation.

Tampering with the product, altering the aforementioned characteristics such as modifying the operation and performing connections other than those indicated in the Installation Instructions in the manual can modify the conditions to which the product is considered approved, with consequential danger for later sale of the product.

## DICHIARAZIONE DI CONFORMITÀ



secondo norme ISO/IEC Guida 22 e EN 45014

**Numero di conformità: 007-2012**

nome del fabbricante: **A.E.B. S.p.A. divisione Antifurti**  
indirizzo: via dell'Industria, 20  
Corte Tegge  
42025 Cavriago (RE)

**DICHIARA SOTTO LA PROPRIA RESPONSABILITÀ CHE L'UNITÀ  
ELETRICA/ELETTRONICA**

Prodotto: Sistema localizzatore **MEDSKY MS10 CAN**

**E' CONFORME ALLE SEGUENTI SPECIFICAZIONI DI PRODOTTO**

CAMPO	DIRETTIVA/ D.L.	Requisiti	Norme applicate	Riferimenti	Esito prova
R&TTE	99/5/CE	Esposizione umana ai campi elettromagnetici (art. 3.1a):	EN 62311:2008	Gazzetta Ufficiale L91 del 7/4/1999	positivo
		Sicurezza elettrica (art. 3.1a):	EN60950		positivo
		EMC (art. 3.1b):	Regolamento ECE R10-03		positivo
		Spettro Radio (art. 3.2)	EN 301 511 (03-2003)		positivo

IL PRODOTTO E' MARCATO CON IL MARCHIO CE E CON IL NUMERO DEL NOTIFIED BODY IN ACCORDO CON L'ANNESSO IV DELLA DIRETTIVA R&TTE 1999/5/CE del 5 Marzo 1999

**CE 0678**

Luogo di emissione: **Cavriago (RE)**

Data di emissione: **11/04/2012**

**L'Amministratore Delegato di A.E.B. S.p.A.**

Fiaccadori Antonia

# INSTALLATION and CONNECTION

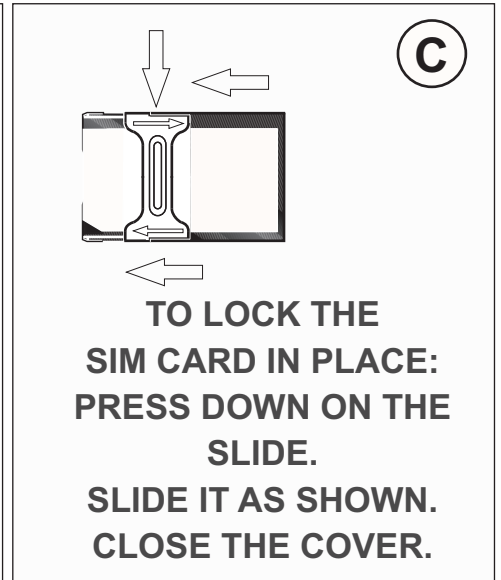
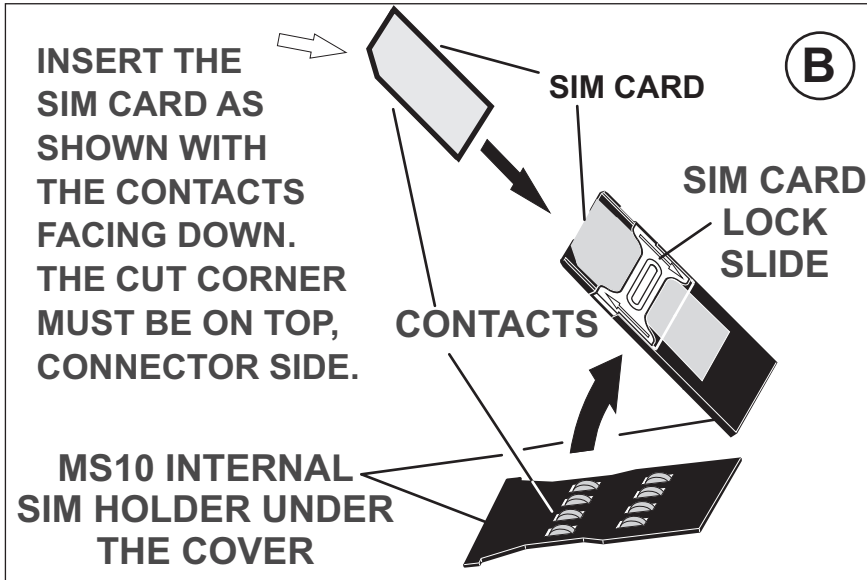
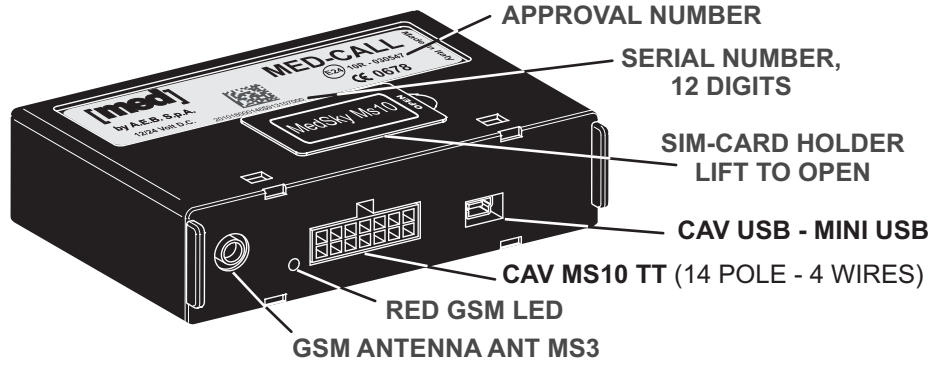
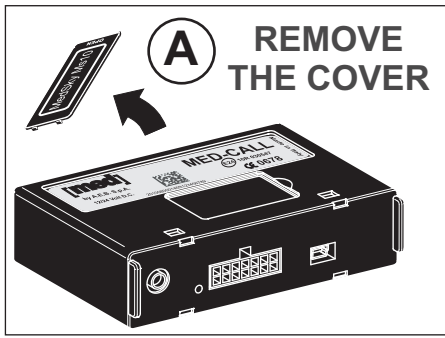

## CONNECTION

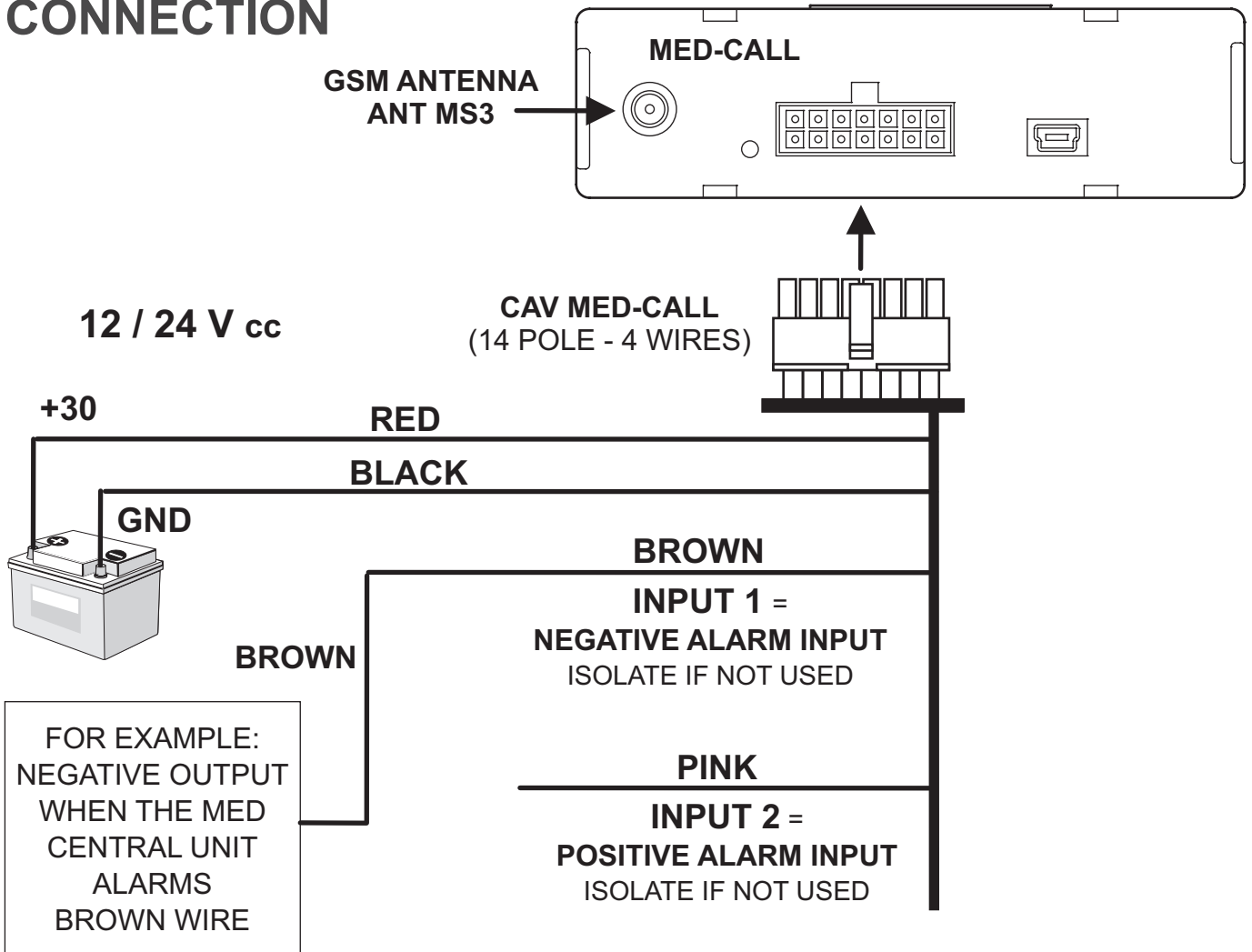

## INSTALLATION PROCEDURE

Before installation, carefully read the all of the instructions for installation and operation.

### SIM CARD

**MED-CALL** only works with a SIM-CARD, which you can purchase from Mobile Phone Operators, and which is only to be put in the module after making sure it works correctly and enabling whatever necessary, as indicated below.

The **SIM CARD** must have at least the "SMS" function, better still if it also has VOICE line, to make calls to the Main Phone.

Remove the following from the **SIM CARD**: **LOCK CODE (PIN) / ANSWERING MACHINE / CALL FORWARDING**

CHECK THAT THE SERVICE CENTRE NUMBER IS ENTERED.

For example, for ITALY: **TIM:+39 335 9609600**      **VODAFONE: +39 349 2000200**

**WARNING: Some telephone cards must be "activated" by making and receiving a telephone call before they are installed in the satellite system.**

- **If the vehicle travels outside the country, make certain that the SIM is enabled for international roaming.**

### GSM ANTENNA

The excess wire must be laid out with wide curves. Do not roll up or cut. Use the antenna provided in the kit.

### POSITIONING / CONNECTIONS

- Install it inside the passenger compartment. Attach it firmly to the vehicle (using screws, silicone, Velcro, etc.), located far away from heat sources.  
Protect from leaks and condensate.
- Suitably isolate the wires that are not used.
- Disconnect the negative pole of the battery before performing the connections.
- Use FAST-ON or weld and suitably insulate the joints. Do not use tap connectors.
- For vehicles with ADR (automatic battery disconnect), please contact the nearest MED Service centre / Distributor / Representative.
- For industrial machines, earth moving equipment, and farm equipment, a waterproof housing is needed with suitable vibration "absorbers".
- For boats, roll-off vehicles, and mobile cases, please contact the nearest MED Service centre / Distributor / Representative.
- **For SECURITY installations, the peripheral and GSM antenna must not be visible.**  
The cables must be inserted in the original runners, covered with protective casing or reinforced tape in the same original vehicle colour, especially where the cables are visible, such as under the hood. Do not use plastic adhesive tape that could come off when exposed to heat.

### TECHNICAL DATA MED-CALL

Power Supply:	: <b>12 or 24 Vcc</b> nominal (8 / 32 Volt)
Current Absorption	: <b>250 mA</b> in transmission, depends on the GSM network : <b>&lt; 4 mA</b> in STAND-BY
Digital Inputs	: <b>2</b> , all active in STAND-BY
Serial interface	: <b>1 USB</b>
Temperature range	: from <b>- 40° C</b> to <b>+ 85° C</b>
Position	: In the passenger compartment, protected from liquid leaks and condensation
Protection	: <b>IP 42</b> (IEC 529 1989) - DIN 40050 - EN 60529
Dimensions	: <b>98 x 71 x 30 mm</b>
Weight	: <b>130 gr</b>
<b>GSM</b> telephone module	: <b>QUAD-BAND 2W 850 / 900 1W 1800 / 1900</b>
<b>SIM-CARD</b> (not supplied)	: <b>1,8 / 3 Volt</b> (not compatible with 5V SIM-CARDS, the old type)

## PERIPHERAL VERSION CHECK BY SMS

Send the **SMS**:

**V** (type only the letter, without spaces)

The MED-CALL will answer with the following SMS:

Message	Generated by	MED-CALL
<b>S/N</b> XXXXXXXXXXXXX:	Version and serial number of the system.	
<b>HW</b> xx.xx	System hardware version.	
<b>BOOT</b> xx.xx	System base software version.	
<b>SW</b> xx.xxx	System1 software version.	
<b>K</b> : xxxx	System configuration.	
<b>T</b> : + xx C	Internal temperature of the MS10 (measured inside, usually greater than the ambient temperature).	

## SYSTEM CONFIGURATION INSPECTION / CHECK BY SMS:

If the system is powered and the antennas are connected, you can send it **SMS** messages:

**I** (only type the letter **I** as in Installation, without spaces)

The MED-CALL will answer with the following SMS:

Message	Generated by	MED-CALL
<b>I1 A</b>	In. 1: Negative input <b>A</b> = no alarm, <b>C</b> = Alarm (ground present).	
<b>I2 A</b>	In. 2: Positive input <b>A</b> = no alarm, <b>C</b> = Alarm (positive present).	
<b>VB : 12.5V</b>	Power supply voltage (main system battery, ex. 12.5 Volt).	
<b>Gsm : X</b>	Telephone signal intensity (field) - <b>4</b> = maximum signal level.	
<b>ST : IS</b>	Status of peripheral: <b>FS</b> = <b>OUT OF SERVICE</b> (In maintenance), <b>IS</b> = In service.	
<b>SAI: CC</b>	<b>CAUTION:</b> Messages <b>V</b> and <b>I</b> can always be sent to MED-CALL, from any mobile phone.	

## SUMMARY OF COMMANDS USEABLE BY SMS

### COMMANDS RESERVED FOR THE MAIN USER - ALWAYS AVAILABLE

Cancel the MAIN telephone registered:	REG OFF
Register secondary user telephone numbers:	RON <+39xxxxxxxxxx>
Display the telephone numbers of the secondary users:	RON
Delete all of the secondary users:	ROFF
Delete one specific secondary user:	ROFF <+39xxxxxxxxxx>
It excludes the silent warning call to the Main User:	TEL OFF
It shows if the silent warning call is available:	TEL
It resets the silent warning call to the Main User:	TEL ON
Limit the access of other telephones:	ACC OFF
Display the type of access set (mobile telephone):	ACC
Allow other telephones access:	ACC ON
Change name of alarm 1 (INPUT 1)	ALL1 XXXXXXXXXXXXXXX
Change name of alarm 2 (INPUT 2)	ALL2 XXXXXXXXXXXXXXX
Reset original names of alarms 1 and 2	ALLD
System OUT OF SERVICE:	COM FS
IN SERVICE enable alarm messages:	COM IS
Restore "OUT OF SERVICE reminder" SMS:	COM FS ON
Exclude "OUT OF SERVICE reminder" SMS:	COM FS OFF
Activate AUTOMATIC SYSTEM CHECK:	COM VERIFICA ON
Set-up AUTOMATIC system CHECK (in minutes):	COM VERIFICA XXXXX
Exclude AUTOMATIC system CHECK:	COM VERIFICA OFF

## SUMMARY OF COMMANDS USEABLE BY SMS

**COMMANDS AVAILABLE FOR ALL USERS** (If the Main User has not blocked access for other users by sending the **ACC OFF** command)

	<b>SMS</b>
Registration of MAIN telephone number (mobile phone):	REG ON
Display the MAIN telephone number (mobile phone):	REG
Request vehicle POSITION by SMS (telephone cell):	POS
System RESET:	RESET

## CERTIFICATE OF GUARANTEE

Thundersigned: \_\_\_\_\_

Installed CERTIFIES that the fitting of the DEVICE described below was carried out by him PERSONALLY, in accordance with the instructions of the manufacturer.

### Description of the VEHICLE:

TRADEMARK: \_\_\_\_\_ TYPE: \_\_\_\_\_

REGISTRAZION NUMBER: \_\_\_\_\_

### Description of the SYSTEM

Type Registration	MED-CALL
----------------------	----------

Apply the supplied labels with the relevant data and complete the form.

Installed at: \_\_\_\_\_ On: \_\_\_\_\_

Full address of installer:

\_\_\_\_\_  
\_\_\_\_\_  
\_\_\_\_\_

SIGNATURE:

\_\_\_\_\_

STAMP
-------

### GENERAL WARNINGS FOR THE USER:

- INSTALLATION must be conducted by QUALIFIED PERSONNEL and according to the instructions.
- The INSTALLED MUST provide the OWNER of the vehicle with the present CERTIFICATE OF GUARANTEE, completed in full and signed.

A.E.B. S.p.A. declines all responsibility and suspends the GUARANTEE if the product or parts thereof are used unsuitably, are tampered with, or if they are connected with devices not listed.

PLEASE WRITE IN BLOCK LETTERS

All rights reserved. © 2015 A.E.B. S.p.A.  
Subject to changes and incorrect information.