

[med]

med 75.15.03



- **POMPA ROTATIVA BOSCH VE O EQUIVALENTE**
- **BOSCH VE ROTARY PUMP OR EQUIVALENT**
- **POMPE ROTATIVE BOSCH VE OU ÉQUIVALENTE**

- **MOLLA DEL TIRANTE STAFFA ACCELERATORE**
- Accelerator bracket tie rod spring
- Ressort du tirant étrier accélérateur

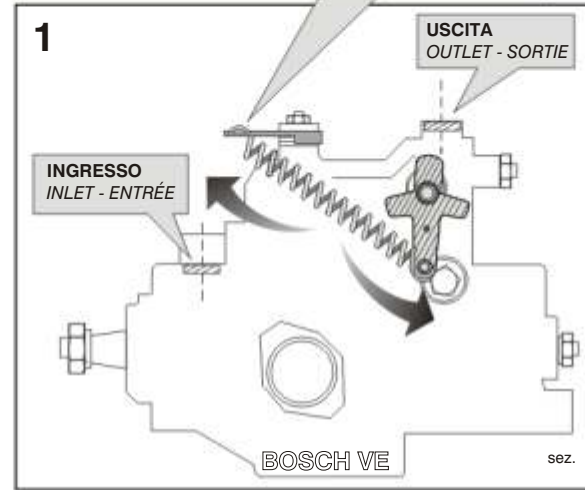

- **SGANCIARE LA MOLLA TIRANTE ACCELERATORE PER IL MONTAGGIO DELL'IMMOBILIZZATORE**
- Release the accelerator tie rod spring to fit the immobiliser
- Débranchez le ressort du tirant de l'accélérateur pour monter l'antivol

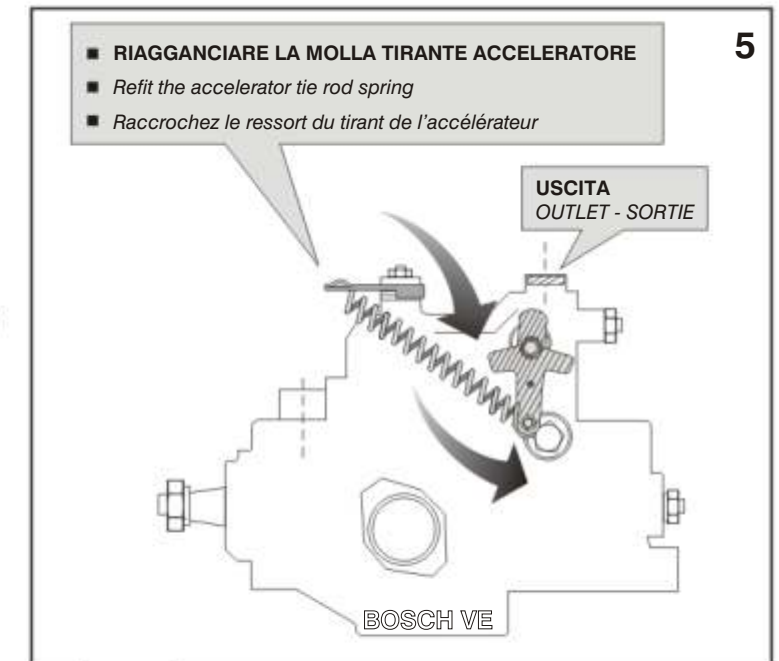
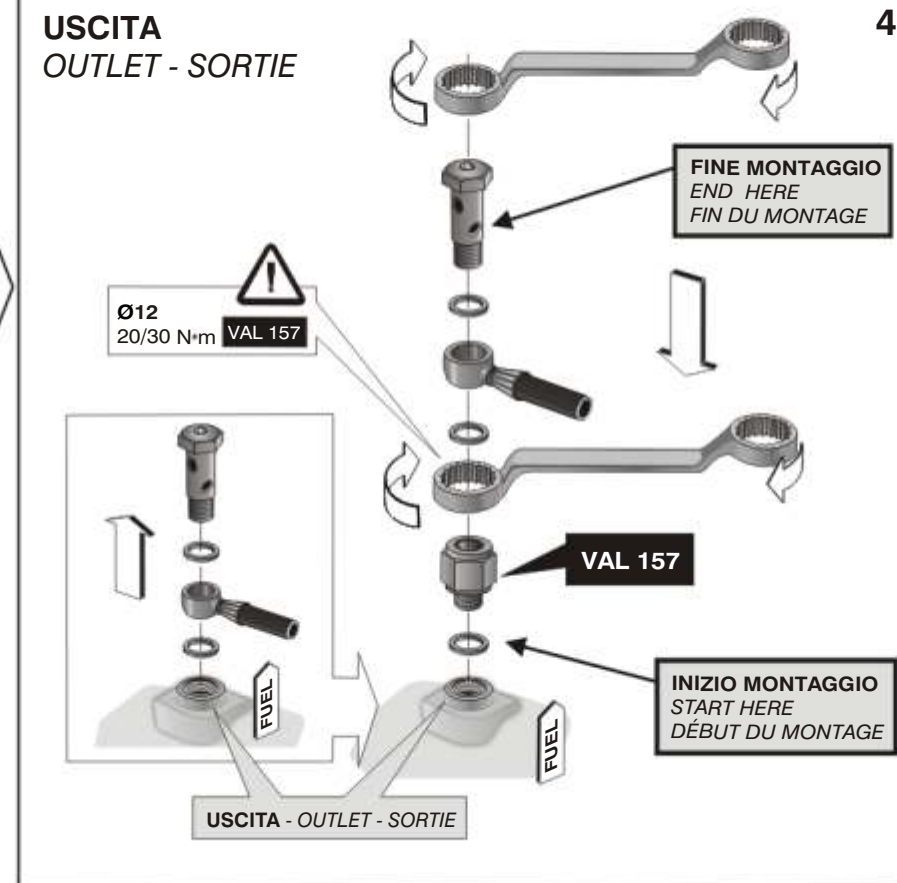
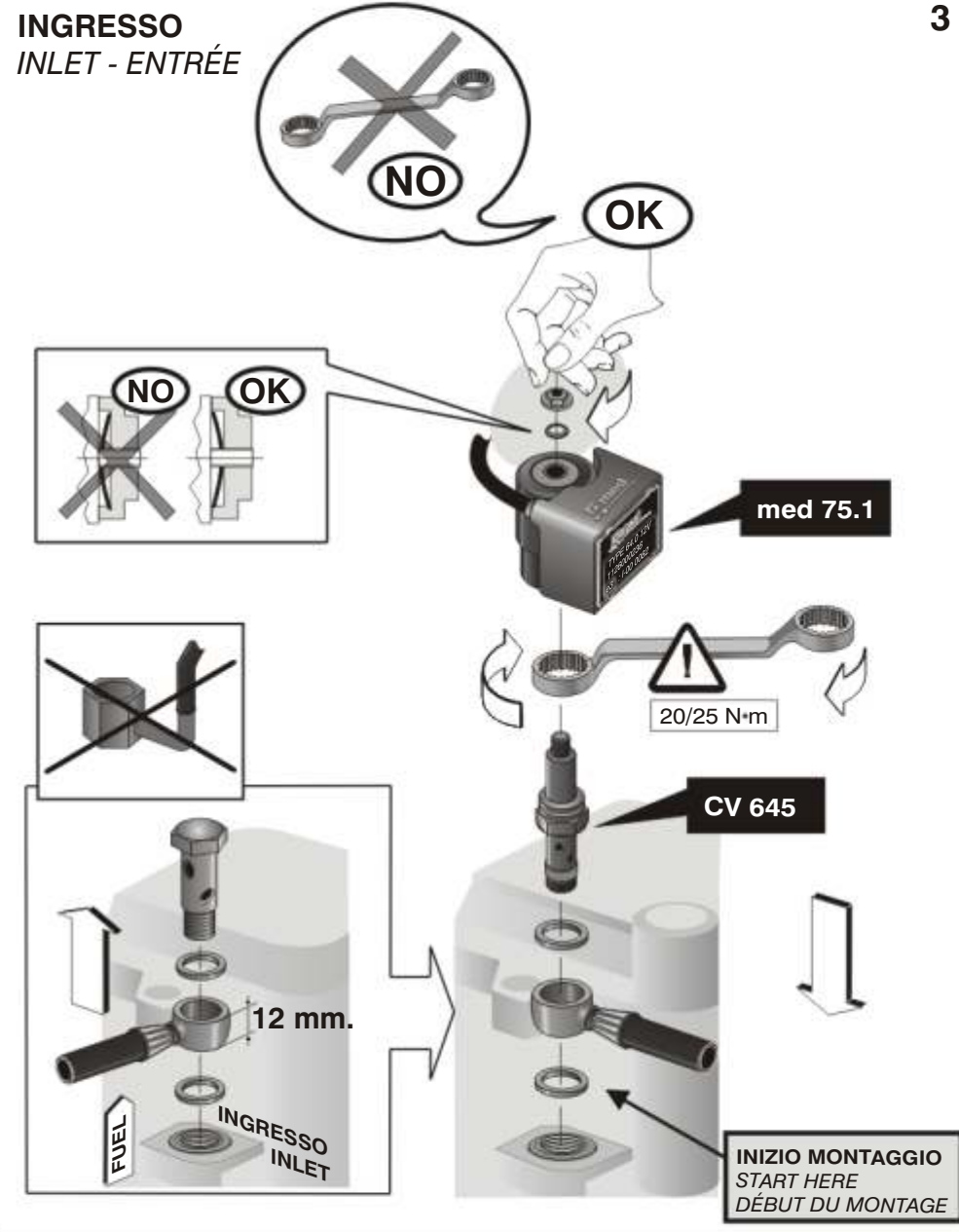
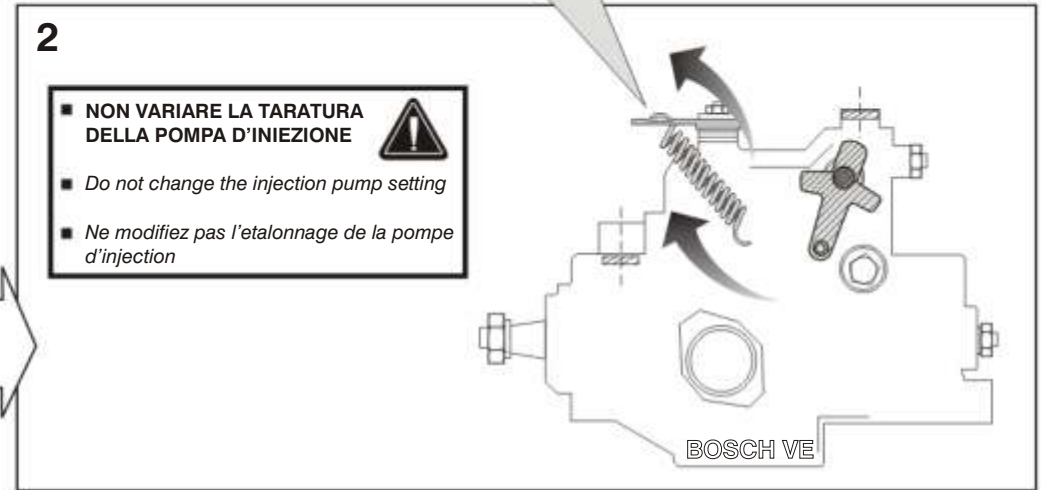

TEST

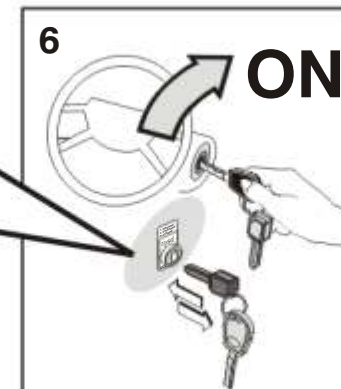
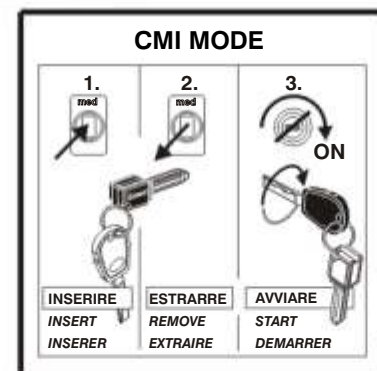

VERIFICA DELL'IMPIANTO
System check

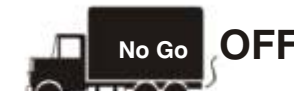

[med]

med S.p.A.
Via Raffaello, 33 - 42100 Reggio Emilia (Italy)
tel. +39 0522 511665 fax +39 0522 500153

www.med-italy.com
e-mail: med.service@med-italy.com

AZIENDA CON SISTEMA QUALITÀ
CERTIFICATO DA DNV
UNI EN ISO 9001

