

med 75.01.07

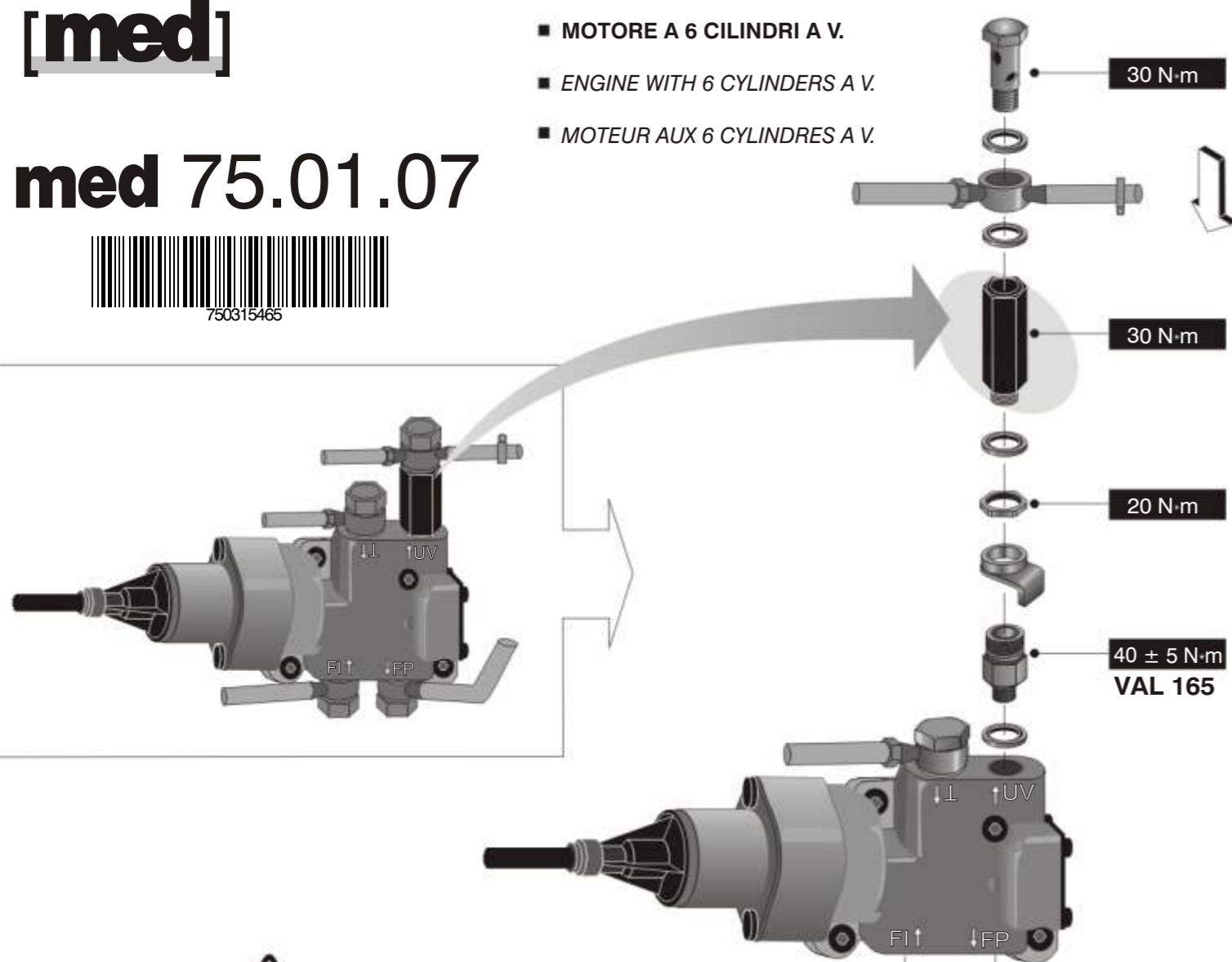

- MOTORE A 6 CILINDRI A V.
- ENGINE WITH 6 CYLINDERS A V.
- MOTEUR AUX 6 CYLINDRES A V.



- Effettuare tutti i collegamenti elettrici prima del collaudo, in particolare l'interruzione sul [+50]
- To effect all the electric connections before the testing, particularly the interruption on [+50]
- Effectuer toutes les liaisons électriques premier de l'essai, en particulier l'interruption sur le [+50]

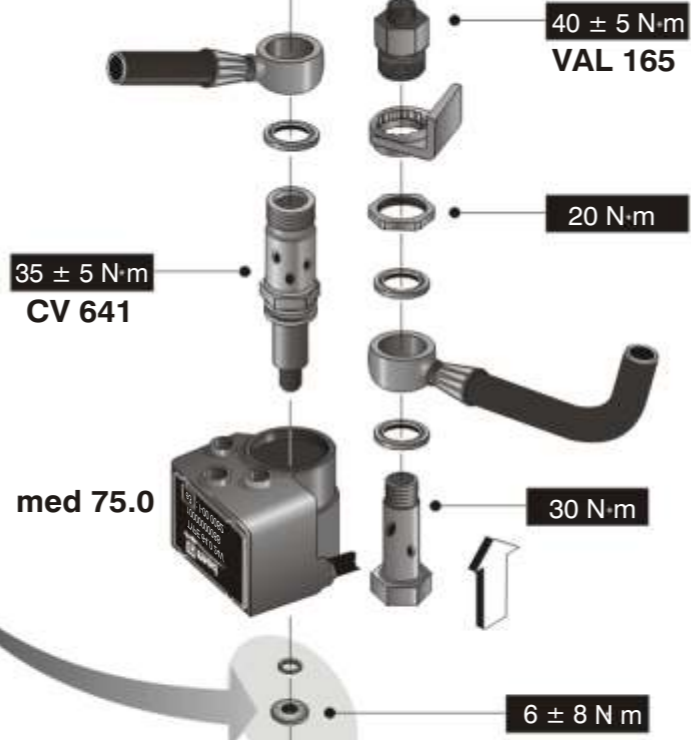
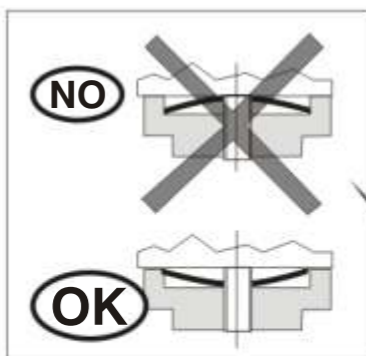

- MOTORE A 8 CILINDRI A V.
- ENGINE WITH 8 CYLINDERS A V.
- MOTEUR AUX 8 CYLINDRES A V.

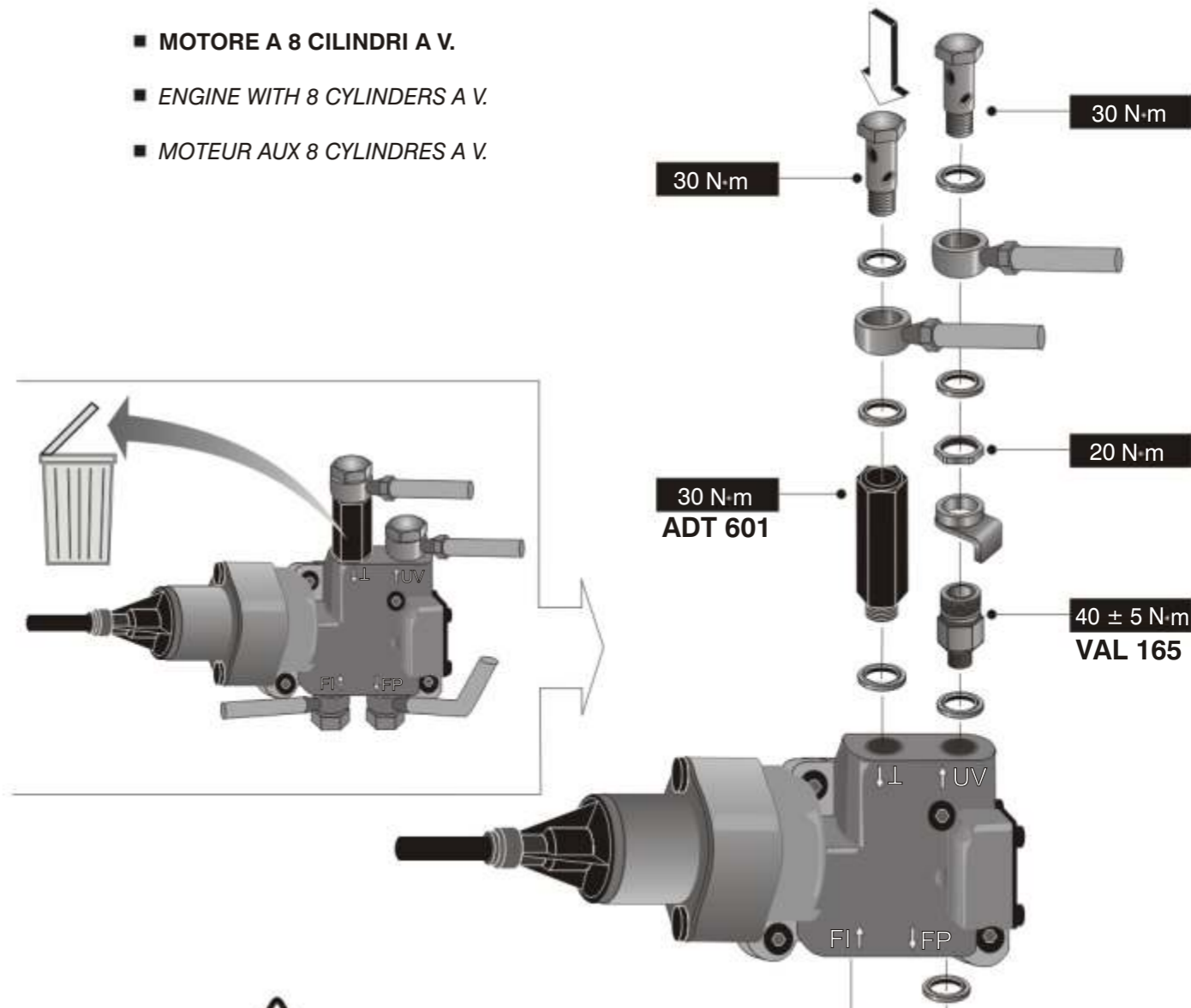

- Effettuare tutti i collegamenti elettrici prima del collaudo, in particolare l'interruzione sul [+50]
- To effect all the electric connections before the testing, particularly the interruption on [+50]
- Effectuer toutes les liaisons électriques premier de l'essai, en particulier l'interruption sur le [+50]

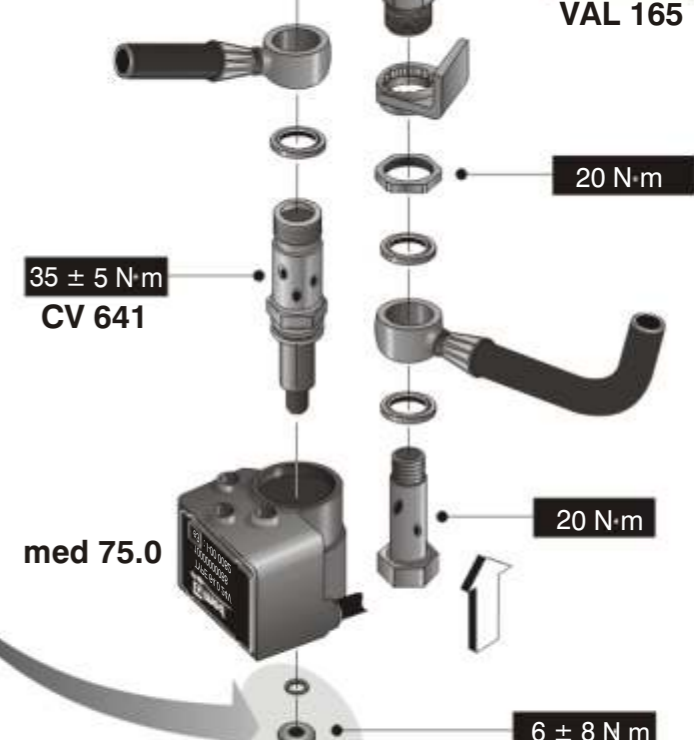
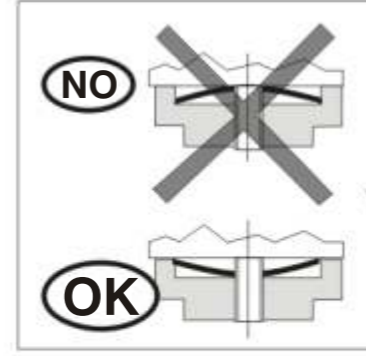

[med]

med 75.01.07



SCANIA SERIE 4 CON "EHAB"



COLLEGAMENTI OBBLIGATORI / OBLIGATORY CONNECTIONS / CONNEXION OBLIGATOIRES

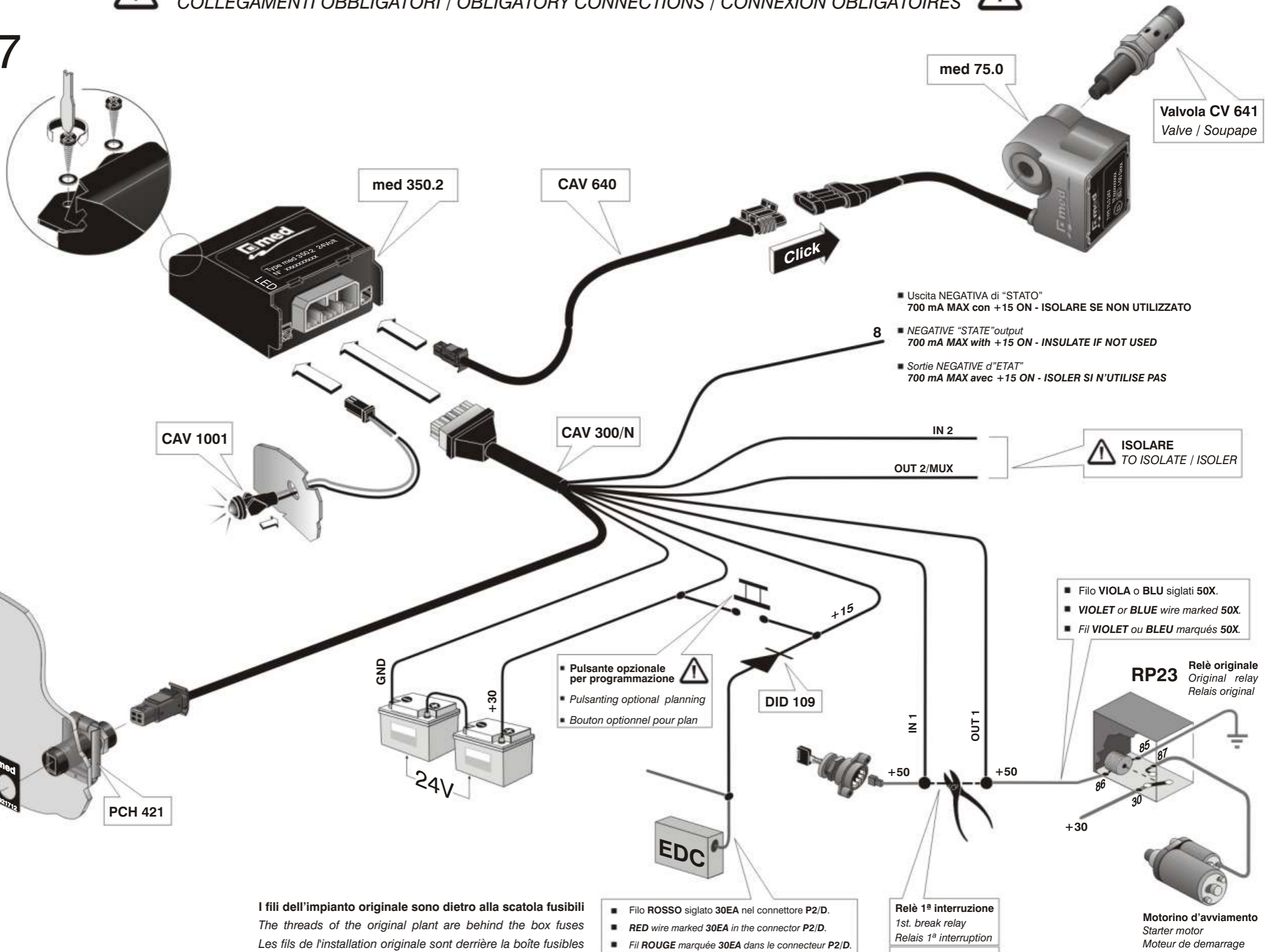

- Uscita NEGATIVA di "STATO"
700 mA MAX con +15 ON - ISOLARE SE NON UTILIZZATO
- NEGATIVE "STATE" output
700 mA MAX with +15 ON - INSULATE IF NOT USED
- Sortie NEGATIVE d"ETAT"
700 mA MAX avec +15 ON - ISOLER SI N'UTILISE PAS

ISOLARE
TO ISOLATE / ISOLER

- Filo VIOLA o BLU siglati 50X.
- VIOLET or BLUE wire marked 50X.
- Fil VIOLET ou BLEU marqués 50X.

RP23 Relè originale
Original relay
Relais original

Motorino d'avviamento
Starter motor
Moteur de démarrage

- Filo ROSSO siglato 30EA nel connettore P2/D.
- RED wire marked 30EA in the connector P2/D.
- Fil ROUGE marquée 30EA dans le connecteur P2/D.
- +15 ritardato allo spegnimento del motore
- +15 delayed to the turning off of the motor
- +15 retardé à l'extinction du moteur

Relè 1ª interruzione
1st. break relay
Relais 1ª interruption

CONTATTO NC
NC CONTACT/CONTACT NC

10A
30A 10 sec.

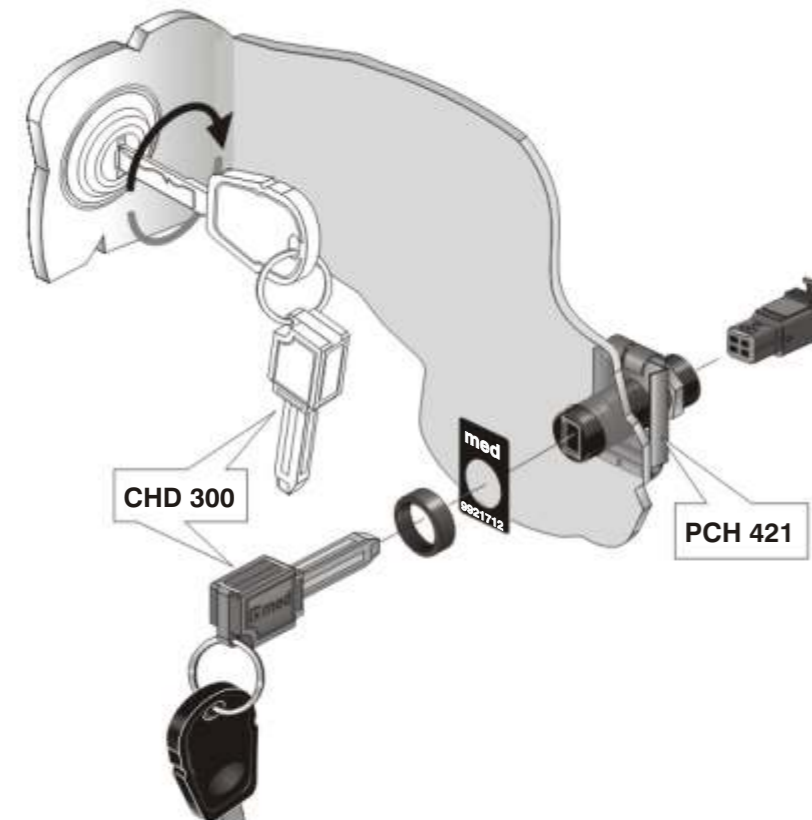
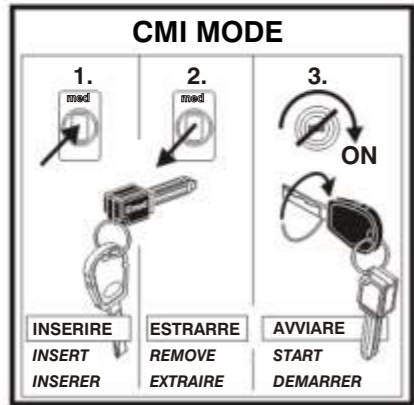

I fili dell'impianto originale sono dietro alla scatola fusibili
The threads of the original plant are behind the box fuses
Les fils de l'installation originale sont derrière la boîte fusibles

[med]

med S.p.A.
Via Raffaello, 33 - 42100 Reggio Emilia (Italy)
tel. +39 0522 511665 fax +39 0522 500153

www.med-italy.com
e-mail: med.service@med-italy.com



AZIENDA CON SISTEMA QUALITÀ
CERTIFICATO DA DNV
UNI EN ISO 9001