

[med]

med 75.03.58



“Volvo FH 12” 10/98→

“Volvo FM 12” 10/98→

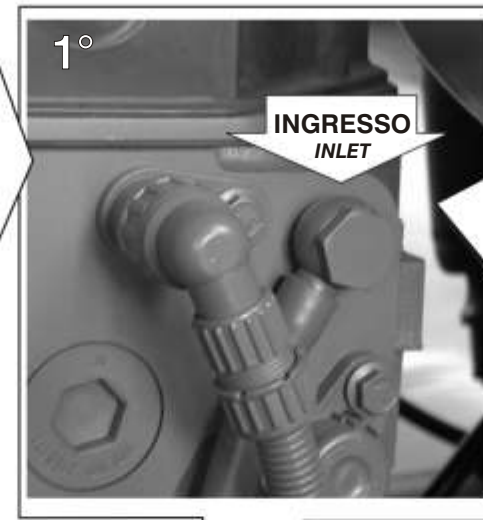
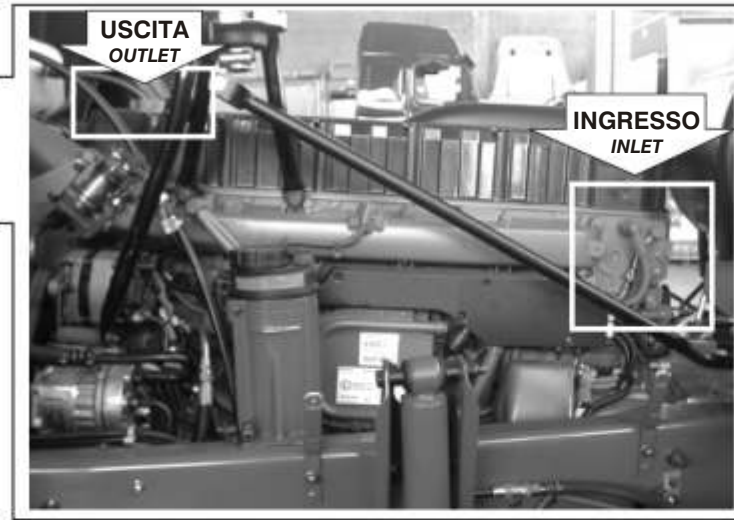

USCITA / OUTLET

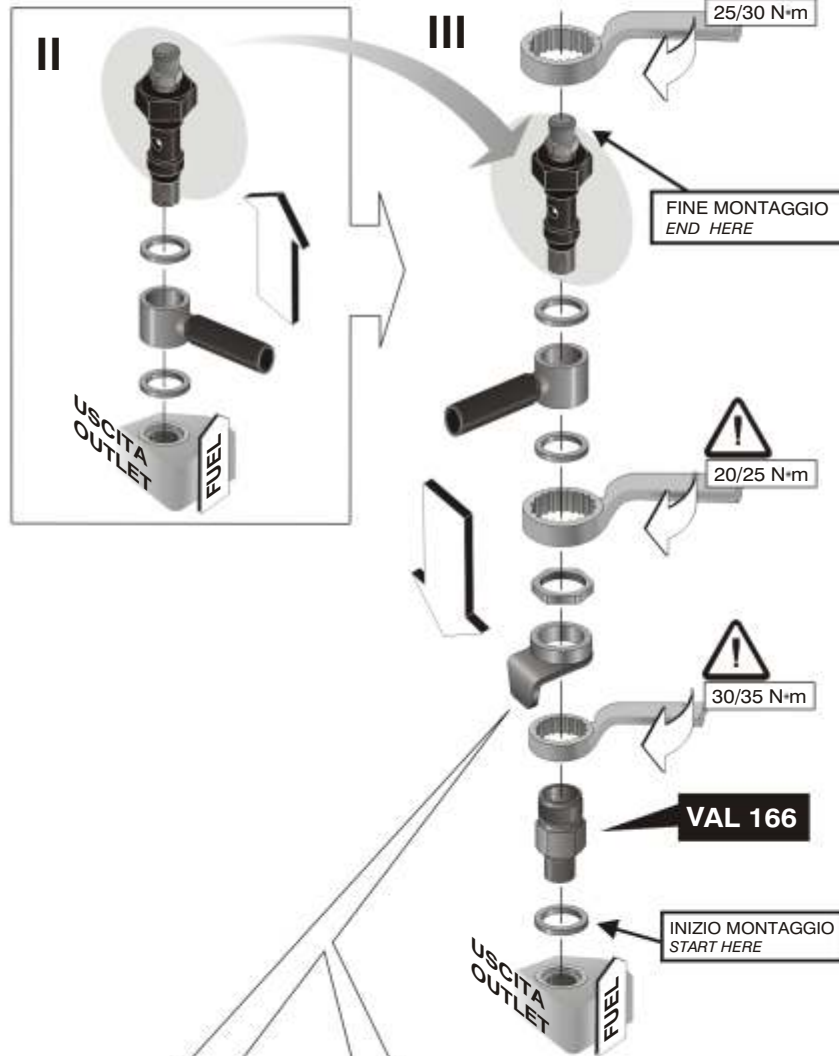

INGRESSO / INLET

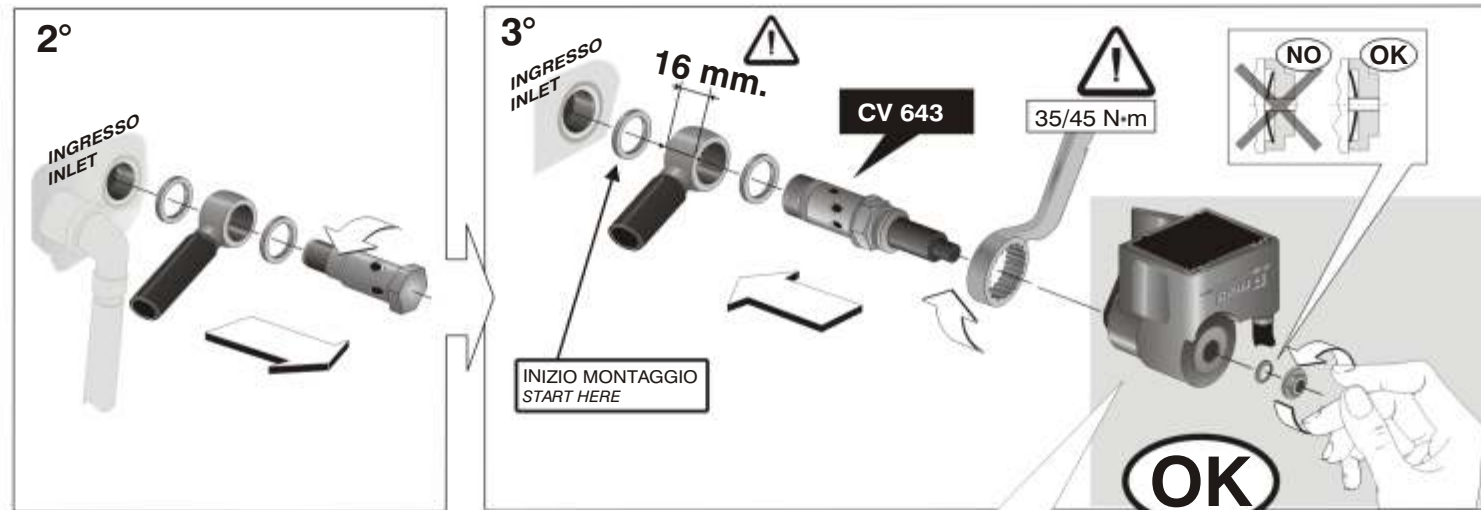

STF 645

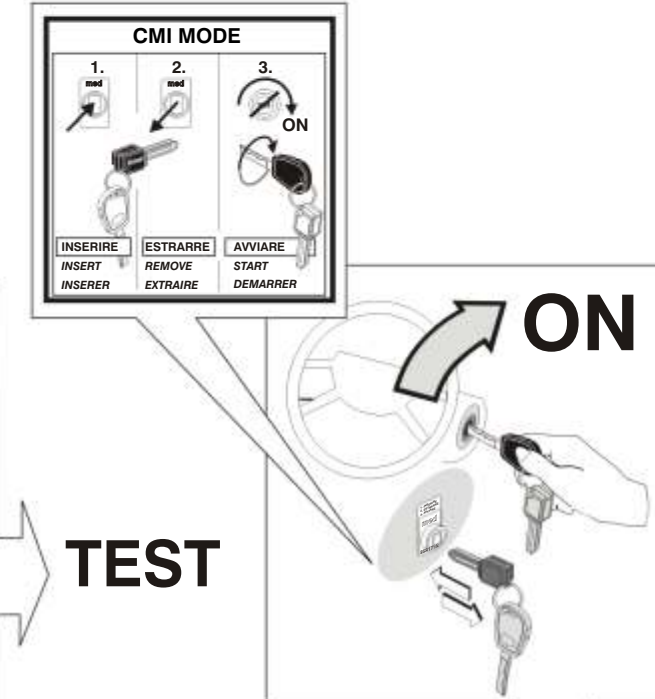
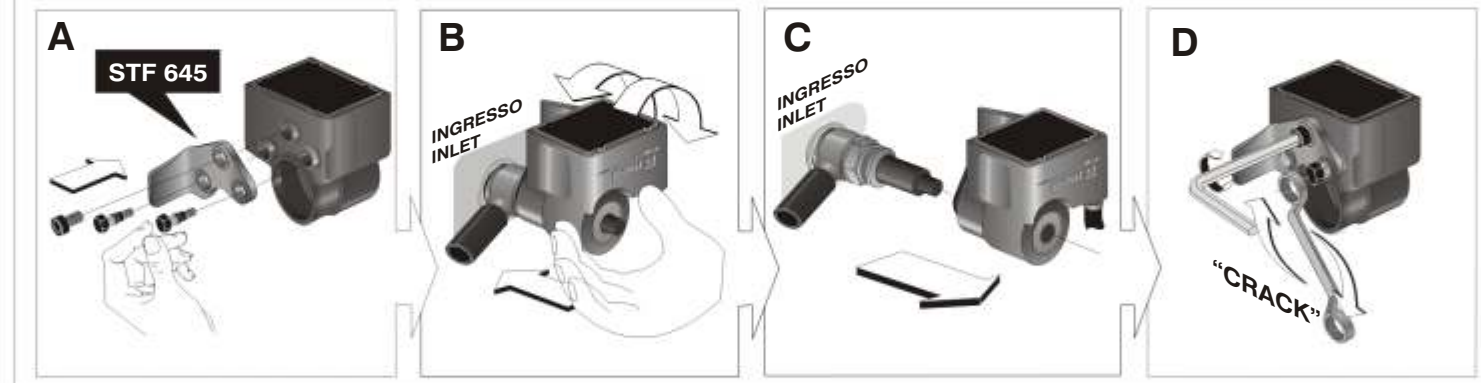

VERIFICA DELL'IMPIANTO / System check

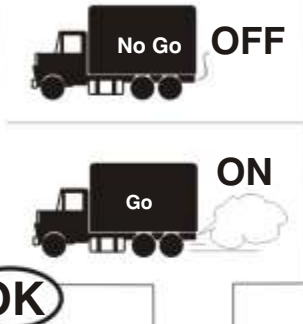

[med]

med S.p.A.
Via Raffaello, 33 - 42100 Reggio Emilia (Italy)
tel. +39 0522 511665 fax +39 0522 500153

www.med-italy.com
e-mail: med.service@med-italy.com



AZIENDA CON SISTEMA QUALITÀ
CERTIFICATO DA DNV
UNI EN ISO 9001

med 75.03.58

COLLEGAMENTO SU "Volvo FH 12" 10/98 → CONNECTION ON "Volvo FM 12" 10/98 →

■ **ATTENZIONE:** Il colore e la posizione dei fili originali sono da ritenersi puramente indicativi, poiché possono verificarsi variazioni ad opera della casa costruttrice.

■ **WARNING:** Color and position of vehicle original wire are to be considered approximate, as some changes may be done by the manufacturer.

